

JAUGES DE FILETAGE NANO CALIBRI FILETTATI PER FILETTATURA NANO

nano

JAUGES TAMPONS DE FILETAGE — CALIBRI A TAMPONE FILETTATI



MÉTROLOGIE — METROLOGIA



PRODUCTION — PRODUZIONE



< 2.74 mm



UTILISATION

Le meulage du 1er filet non plein et de la face avant de la jauge garantit un engagement optimal dans le filetage, primordial pour assurer une mesure correcte. Cette entrée permet à la jauge de contrôler le filetage à une profondeur maximale.



MAÎTRISE DU PROFIL

Notre savoir-faire dans le domaine de la rectification nous garantit une parfaite maîtrise des tolérances de la forme du profil et des états de surface parfaits.



JAUGE BAGUE NO-GO

Le dégagement du \varnothing extérieur de nos jauges bagues NO-GO assure une vérification parfaite des flancs de vis en éliminant le risque d'un contrôle faussé par un blocage sur le diamètre extérieur de la jauge.



SYSTÈME MODULAIRE

Une vis de raccord permet d'assembler la jauge GO avec la partie NO-GO selon votre besoin. La boîte rigide sécurise les jauges pendant le transport et les déplacements. Son intérieur moulé protège le produit des chocs et des salissures.

TAMPONS RAPPORTEURS — TAMPONI DI CONTROLLO

Le tampon rapporteur NO-GO sera le garde-fou de la nouvelle bague.

Il tampone di controllo NO-GO è il dispositivo di controllo per il nuovo calibro ad anello.

Le tampon rapporteur GO servira à contrôler la qualité de votre bague.

Il tampone di controllo GO viene utilizzato per controllare la qualità del vostro calibro ad anello.



Le témoin d'usure WEAR prolongera la durée de vie de votre bague jusqu'à un certain seuil de tolérance.

Il tampone master WEAR prolunga la vita utile del vostro tampone ad anello fino ad un certo limite di tolleranza.

UTILIZZAZIONE

Il fatto che il giro iniziale della filettatura della vite e anche la punta del calibro siano stati rettificati in piano assicura che l'utensile si inserisca in modo ottimale nella filettatura, il che è essenziale per garantire una misurazione corretta. Ciò consente al calibro di controllare il filetto alla sua massima profondità.

CONTROLLO DEL PROFILO

La nostra esperienza nel campo della rettifica ci assicura un perfetto controllo delle tolleranze per la forma del profilo e per la struttura delle superfici.

CALIBRO AD ANELLO NO-GO

Il profilo sul diametro esterno dei nostri tamponi ad anello NO-GO garantisce un controllo ottimale dei lati della vite, eliminando il rischio di una verifica errata causata da un blocco del diametro esterno del calibro.

SISTEMA MODULARE

Una vite di accoppiamento consente di collegare il calibro GO alla sezione NO-GO come richiesto. La scatola rigida protegge i calibri durante il trasporto. Il suo interno stampato mantiene il prodotto pulito e lo protegge dagli urti.

LE CERTIFICAT DE MESURE SCS



Un certificat est une confirmation écrite attestant de la qualité de l'équipement métrologique de l'entreprise. DC NANO TOOLS SA (Accréditation SCS 0143), membre du Groupe DC SWISS, vous propose le contrôle et l'étalonnage des jauges filetées selon la norme internationale standardisée ISO 17025.

Ce service payant est proposé dans les dimensions allant du diamètre 0.1 à 3.0 mm pour la mesure du diamètre sur flanc et de 0.1 à 3.5 mm pour le diamètre extérieur.

Toutes les jauges tampons sont certifiées SCS.

Accrédité ISO 17025:2017 © DC NANO TOOLS SA

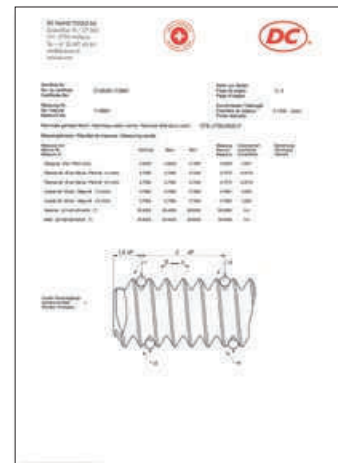
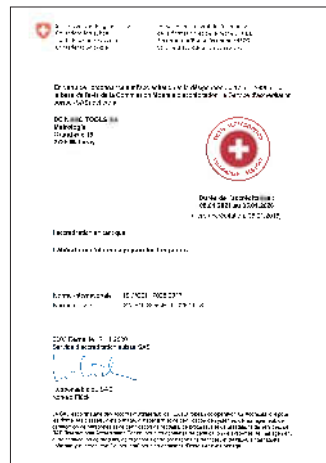

CERTIFICATO DI MISURA SCS



Un certificato è una conferma scritta della qualità delle apparecchiature metrologiche di un'azienda. DC NANO TOOLS SA (accreditamento SCS 0143), membro del Gruppo DC SWISS, può ispezionare e calibrare per voi i tamponi di controllo delle filettature secondo la norma internazionale ISO 17025.

Questo servizio a pagamento è disponibile per diametri di passo da 0.1 a 3.0 mm e per diametri esterni da 0.1 a 3.5 mm.

Tutti i tamponi filettati sono certificati SCS.

Accreditati ISO 17025:2017 © DC NANO TOOLS SA

TÉLÉCHARGEZ VOTRE ATTESTATION DE CONFORMITÉ

Désormais, retrouvez votre attestation de conformité n'importe où directement depuis votre téléphone. Il vous suffit de scanner le QR Code de la carte se trouvant à l'intérieur de la boîte et de télécharger le PDF joint.

L'attestation de conformité accompagnant chaque boîte confirme que la production a scrupuleusement suivi le processus de contrôle au terme de la fabrication.

Contrôle qualité DC SWISS SA



SCARICA LA VOSTRA CONFERMA DI CONFORMITÀ

Ora potete accedere alla vostra conferma di conformità in qualsiasi momento, in qualsiasi posto del vostro telefono. Basta scansionare il codice QR sulla scheda all'interno della scatola e scaricare il file pdf associato.

La conferma di conformità che accompagna ogni scatola conferma che la fabbrica ha seguito scrupolosamente il processo di monitoraggio post-produzione.

Controllo qualità DC SWISS SA

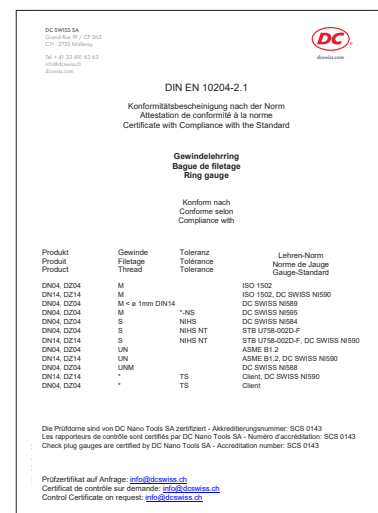



DC

LES SETS DISPONIBLES — SET DISPONIBILI



**JAUGES TAMPONS ET BAGUES DN
CALIBRI A TAMPONE E ANELLI FILETTATI DN**

SET UNITAIRE — SINGOLO SET



**JAUGES BAGUES DZ
ANELLI FILETTATI DZ**

SET UNITAIRE — SINGOLO SET



**JAUGES TAMPONS DN / BAGUES DN
CALIBRI A TAMPONE DN / ANELLI FILETTATI DN**

**SET DE 10 OU 20 PIÈCES
SET DA 10 O 20 PEZZI**

*Pour chaque set, vous pouvez sélectionner
le nombre exact de jauges GO / NO-GO.*

Contactez-nous pour toute autre composition de set.

*È possibile selezionare il numero esatto di calibri
filettati di controllo GO / NO-GO per ogni set.*

Contattateci per qualsiasi altra composizione di set.

dcswiss.com / info@dcswiss.ch / +41 32 491 63 63

COMMANDE DE JAUGES NANO — ORDINE DEI CALIBRI FILETTATI NANO

TYPE D'OUTIL — TIPO DI STRUMENTO







CARACTÉRISTIQUES — CARATTERISTICHE

DIMENSION DIMENSIONE	TOLÉRANCE TOLLERANZA	NORME NORMA	QUANTITÉ QUANTITÀ	SPÉCIFIQUE SPECIFICHE



REMARQUES — NOTE

INFORMATIONS D'EXPÉDITION — INFORMAZIONI SULLA CONSEGNA

Merci de viser votre commande.
Grazie per firmare l'ordine.



	Jauges tampons de filetage Calibri a tampone filettati			Jauges bagues de filetage Anelli filettati				Tampons rapporteurs Tamponi di controllo a spina			
Caractéristiques Caratteristiche											
Type Tipo	DN01 GO	DN01 GO	DN02 NO-GO	DZ04 GO	DZ14 NO-GO	DN04 GO	DN14 NO-GO	RN05-1 GO	RN15-1 GO	RN05-2 NO-GO	RN15-2 NO-GO
M 4H / 5h ISO DIN 14 ISO DIN 13		382	382	383	383	384	384	399	399	400	400
M 6H / 6g ISO DIN 13		382	382	383	383	384	384	399	399	400	400
M 5H / 6h ISO DIN 13		382	382	383	383	384	384	399	399	400	400
MF 4H / 4h ISO DIN 13		385	385	386	386	387	387	402	402	403	403
MF 6H / 6g ISO DIN 13		385	385	386	386	387	387	402	402	403	403
MF 6h ISO DIN 13				386	386	387	387	402	402	403	403
UNC 2B / 2A ASME B1.1		388	388	389	389	390	390	405	405	406	406
UNC 3B / 3A ASME B1.1		388	388	389	389	390	390	405	405	406	406
UNF 2B / 2A ASME B1.1		388	388	389	389	390	390	405	405	406	406
UNF 3B / 3A ASME B1.1		388	388	389	389	390	390	405	405	406	406
S NIHS 3G NIHS	391										
S NIHS 4H NIHS		391									
S NIHS 4H / 3G NIHS			391								
S NIHS NIHS				393	393	394	394	407	407	408	408
S NIHS NT NIHS		392	392	393	393	394	394	407	407	408	408
SF NIHS 3G NIHS	395										
SF NIHS 4H NIHS		395									
SF NIHS 4H / 3G NIHS			395								
SF NIHS NIHS				396	396	397	397	409	409	410	410
SF NIHS NT NIHS								409	409	410	410
SL SL 15-01		398	398								

	Témoins d'usure Testimone di usura		Jauges étalons filetées Campioni filettati
Caractéristiques Caratteristiche			
			
Type Tipo	RN05-3	RN15-3	EN00
M 4H / 5h	ISO DIN 14 ISO DIN 13		
M 6H / 6g	ISO DIN 14 ISO DIN 13	401	401
M 5H / 6h	ISO DIN 13	401	401
MF 4H / 4h	ISO DIN 13	404	404
MF 6H / 6g	ISO DIN 13	404	404
MF 6h	ISO DIN 13	404	404
S NIHS	NIHS		411

Pictogrammes - Simboli

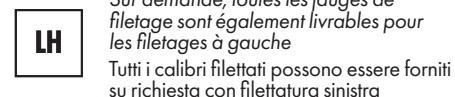
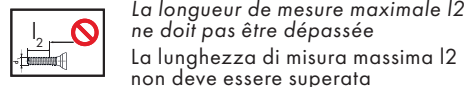
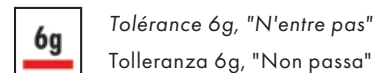
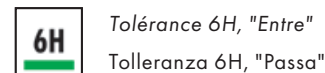
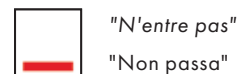

Utilisation — Utilizzazione

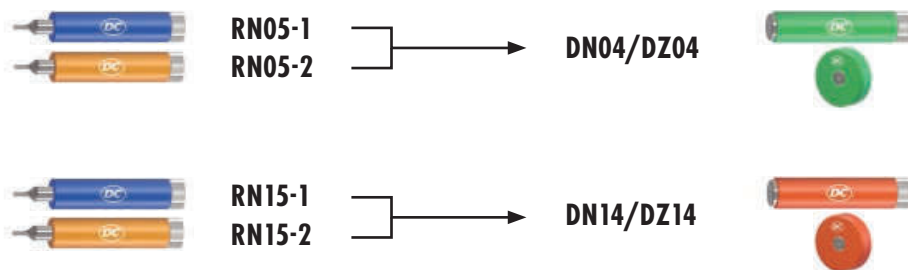

nano

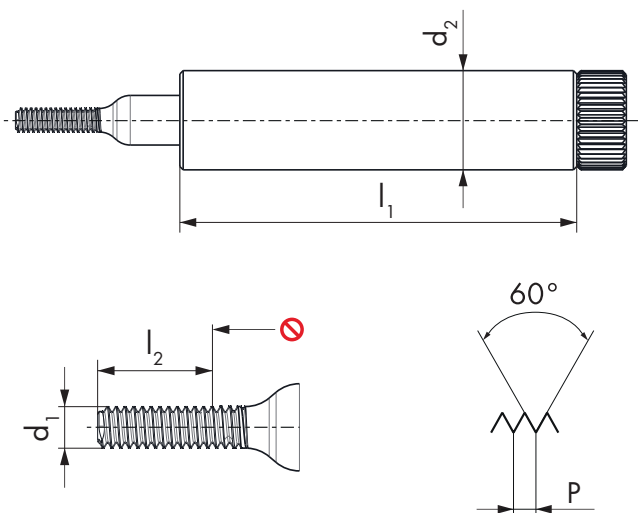

DN01 GO

DN02 NO-GO

DN01 GO

DN02 NO-GO



4H

4H

5H

5H

$\emptyset d_1$ M	P mm	l_1 mm	l_2 GO mm	d_2 mm	ID	ID	ID	ID
0.3	0.08	24	0.9	6	● 192778	● 192786		
0.35	0.09	24	1.05	6	● 192779	● 192787		
0.4	0.1	24	1.2	6	● 192780	● 192788		
0.5	0.125	24	1.5	6	● 192781	● 192789		
0.6	0.15	24	1.8	6	● 192782	● 192790		
0.7	0.175	24	2.1	6	● 192783	● 192791		
0.8	0.2	24	2.4	6	● 192784	● 192792		
0.9	0.225	24	2.7	6	● 192785	● 192793		
1	0.25	24	3	6	● 191113	● 191127	● 191421	● 191424
1.2	0.25	24	3.6	6	● 191114	● 191128	● 191422	● 191425
1.4	0.3	24	4.2	6	● 191115	● 191129	● 191423	● 191426

6H

6H

$\emptyset d_1$ M	P mm	l_1 mm	l_2 GO mm	d_2 mm	ID	ID
1.6	0.35	24	4.5	6	● 191427	● 191433
1.8	0.35	24	4.5	6	● 191428	● 191434
2	0.4	24	4.5	6	● 191429	● 191435
2.3	0.4	24	4.5	6	● 191430	● 191436
2.5	0.45	24	4.5	6	● 191431	● 191437
2.6	0.45	24	4.5	6	● 191432	● 191438



All nano thread plug gauges are SCS-certified and the paid certificate is available on request.

nano

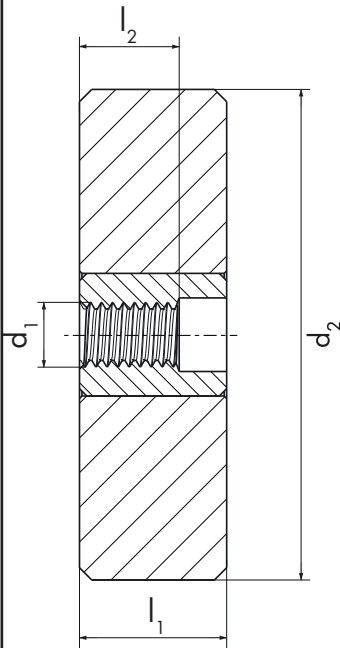

DZ04 GO

DZ14 NO-GO

DZ04 GO

DZ14 NO-GO



5h

5h

6h

6h

$\emptyset d_1$ M	P mm	l_1 mm	l_2 GO mm	d_2 mm	ID	ID	ID	ID
* 0.3	0.08	6	0.45	20	● 192842	● 192850		
* 0.35	0.09	6	0.53	20	● 192843	● 192851		
0.4	0.1	6	0.6	20	● 192844	● 192852		
0.5	0.125	6	0.75	20	● 192845	● 192853		
0.6	0.15	6	0.9	20	● 192846	● 192854		
0.7	0.175	6	1.05	20	● 192847	● 192855		
0.8	0.2	6	1.2	20	● 192848	● 192856		
0.9	0.225	6	1.35	20	● 192849	● 192857		
1	0.25	6	1.5	20			● 191473	● 191476
1.2	0.25	6	1.8	20			● 191474	● 191477
1.4	0.3	6	2.1	20			● 191475	● 191478
* In development								

6g

6g

$\emptyset d_1$ M	P mm	l_1 mm	l_2 GO mm	d_2 mm	ID	ID
1.6	0.35	6	2.4	20	● 191479	● 191485
1.8	0.35	6	2.7	20	● 191480	● 191486
2	0.4	6	3	20	● 191481	● 191487
2.3	0.4	6	3.45	20	● 191482	● 191488
2.5	0.45	6	3.75	20	● 191483	● 191489
2.6	0.45	6	3.9	20	● 191484	● 191490



All nano ring gauges have a certificate of measurement, established with SCS certified plug check gauges. The paid certificate is available on request.



nano

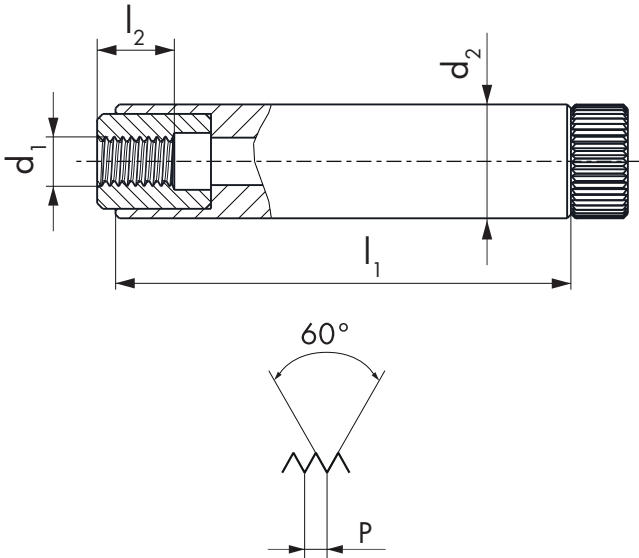

DN04 GO DN14 NO-GO DN04 GO DN14 NO-GO



$\emptyset d_1$ M	P mm	l_1 mm	l_2 GO mm	d_2 mm	ID	ID	ID	ID
* 0.3	0.08	24	0.45	6	● 192800	● 192808		
* 0.35	0.09	24	0.53	6	● 192801	● 192809		
0.4	0.1	24	0.6	6	● 192802	● 192810		
0.5	0.125	24	0.75	6	● 192803	● 192811		
0.6	0.15	24	0.9	6	● 192804	● 192812		
0.7	0.175	24	1.05	6	● 192805	● 192813		
0.8	0.2	24	1.2	6	● 192806	● 192814		
0.9	0.225	24	1.35	6	● 192807	● 192815		
1	0.25	24	1.5	6			● 191447	● 191450
1.2	0.25	24	1.8	6			● 191448	● 191451
1.4	0.3	24	2.1	6			● 191449	● 191452
* In development								



$\emptyset d_1$ M	P mm	l_1 mm	l_2 GO mm	d_2 mm	ID	ID
1.6	0.35	24	2.4	6	● 191453	● 191459
1.8	0.35	24	2.7	6	● 191454	● 191460
2	0.4	24	3	6	● 191455	● 191461
2.3	0.4	24	3.45	6	● 191456	● 191462
2.5	0.45	24	3.75	6	● 191457	● 191463
2.6	0.45	24	3.9	6	● 191458	● 191464



All nano ring gauges have a certificate of measurement, established with SCS certified plug check gauges. The paid certificate is available on request.

nano

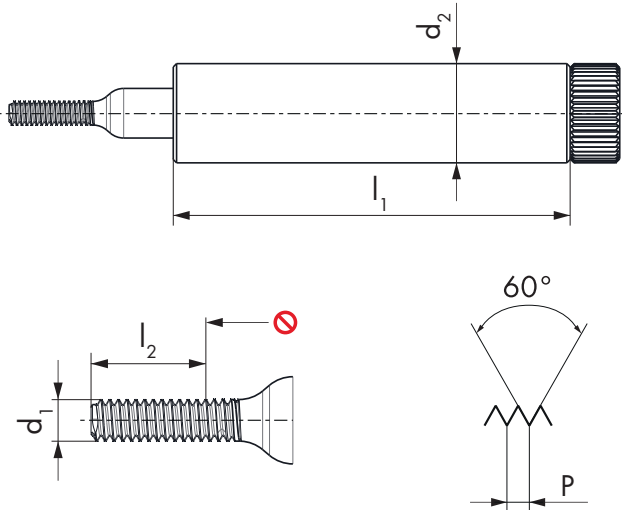

DN01 GO DN02 NO-GO DN01 GO DN02 NO-GO



4H **4H** **6H** **6H**

$\varnothing d_1$ MF	P mm	l_1 mm	l_2 GO mm	d_2 mm	ID	ID	ID	ID
1.4	0.2	24	4.2	6	● 191116	● 191130		
1.6	0.2	24	3	6	● 191117	● 191131		
1.8	0.2	24	3	6	● 191118	● 191132		
2	0.2	24	3	6	● 191119	● 191133		
2	0.25	24	3	6	● 192794	● 192797		
2.2	0.2	24	3	6	● 191120	● 191134		
2.2	0.25	24	3	6	● 191121	● 191135		
2.3	0.2	24	3	6	● 191122	● 191136		
2.3	0.25	24	3	6	● 191123	● 191137		
2.5	0.2	24	3	6	● 191124	● 191138		
2.5	0.25	24	3	6	● 191125	● 191139		
2.5	0.35	24	4.5	6			● 192795	● 192798
2.6	0.35	24	4.5	6			● 192796	● 192799

nano



All nano thread plug gauges are SCS-certified and the paid certificate is available on request.

nano

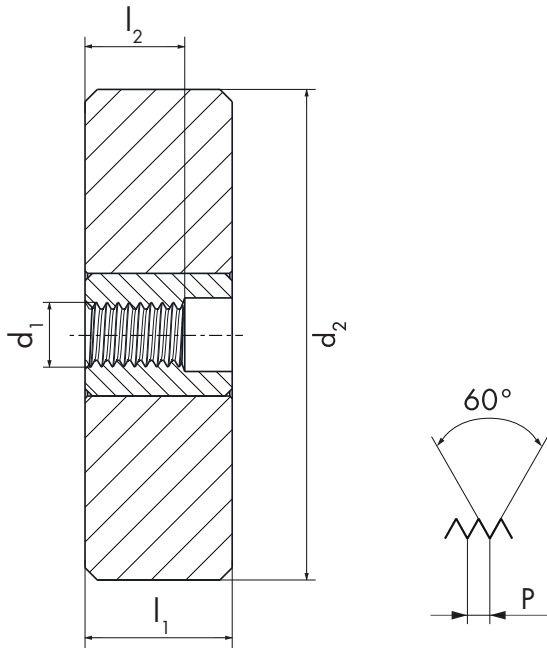

DZ04 GO

DZ14 NO-GO

DZ04 GO

DZ14 NO-GO



4h

4h

6g

6g

$\emptyset d_1$ MF	P mm	l_1 mm	l_2 GO mm	d_2 mm	ID	ID	ID	ID
1.4	0.2	6	2.1	20	● 194887	● 194888	● 192858 ¹	● 192871 ¹
1.6	0.2	6	1.8	20	● 191201	● 191215	● 191229	● 191243
1.8	0.2	6	1.8	20	● 191202	● 191216	● 191230	● 191244
2	0.2	6	1.8	20	● 190711	● 190710	● 191231	● 191245
2	0.25	6	2.25	20	● 194872	● 190690	● 194876	● 194877
2.2	0.2	6	1.8	20	● 191204	● 191218	● 191232	● 191246
2.2	0.25	6	2.25	20	● 191205	● 191219	● 191233	● 191247
2.3	0.2	6	1.8	20	● 191206	● 191220	● 191234	● 191248
2.3	0.25	6	2.25	20	● 191207	● 191221	● 191235	● 191249
2.5	0.2	6	1.8	20	● 191208	● 191222	● 191236	● 191250
2.5	0.25	6	2.25	20	● 194873	● 191223	● 191237	● 191251
2.5	0.35	6	3.75	20			● 192869	● 192882
2.6	0.35	6	3.9	20			● 192870	● 192883

¹ Tol. 6h



All nano ring gauges have a certificate of measurement, established with SCS certified plug check gauges. The paid certificate is available on request.

nano

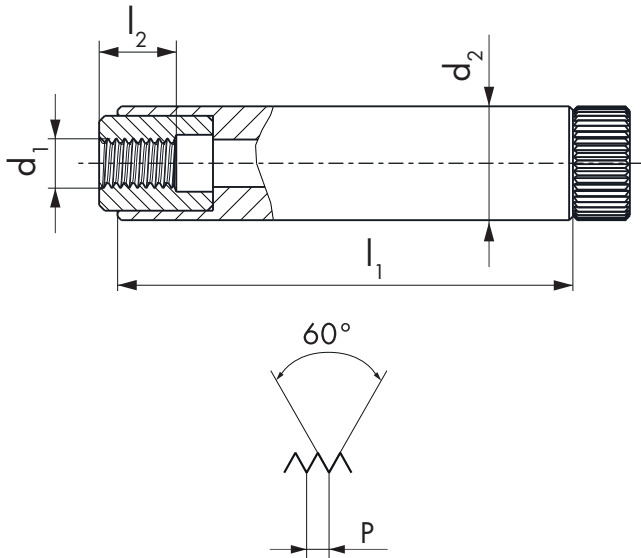

DN04 GO

DN14 NO-GO

DN04 GO

DN14 NO-GO



$\emptyset d_1$ MF	P mm	l_1 mm	l_2 GO mm	d_2 mm	ID	ID	ID	ID
1.4	0.2	24	2.1	6	● 194885	● 194886	● 192816 ¹	● 192829 ¹
1.6	0.2	24	1.8	6	● 191145	● 191159	● 191173	● 191187
1.8	0.2	24	1.8	6	● 191146	● 191160	● 191174	● 191188
2	0.2	24	1.8	6	● 191147	● 191161	● 191175	● 191189
2	0.25	24	2.25	6	● 194870	● 194871	● 194874	● 194875
2.2	0.2	24	1.8	6	● 191148	● 191162	● 191176	● 191190
2.2	0.25	24	2.25	6	● 191149	● 191163	● 191177	● 191191
2.3	0.2	24	1.8	6	● 191150	● 191164	● 191178	● 191192
2.3	0.25	24	2.25	6	● 191151	● 191165	● 191179	● 191193
2.5	0.2	24	1.8	6	● 191152	● 191166	● 191180	● 191194
2.5	0.25	24	2.25	6	● 191153	● 191167	● 191181	● 191195
2.5	0.35	24	3.75	6			● 192827	● 192840
2.6	0.35	24	3.9	6			● 192828	● 192841

¹ Tol. 6h



All nano ring gauges have a certificate of measurement, established with SCS certified plug check gauges. The paid certificate is available on request.

UNC, UNF ASME B1.1 ASME B1.2

VHM
CAR

nano

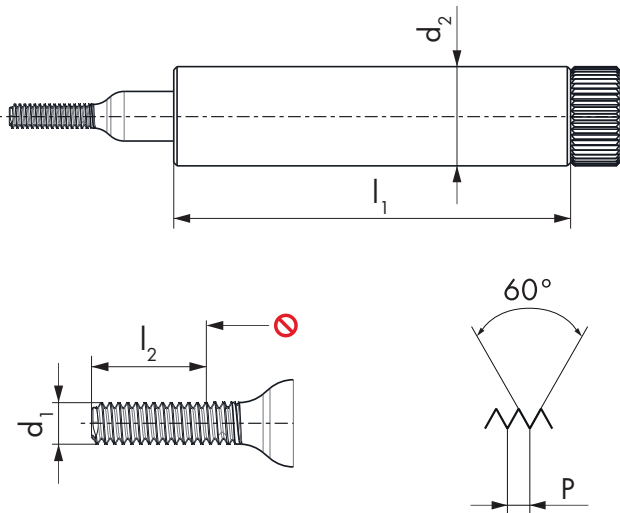

DN01 GO

DN02 NO-GO

DN01 GO

DN02 NO-GO



2B

2B

3B

3B

$\emptyset d_1$ UNC	P TPI	$\emptyset d_1$ mm	l_1 mm	l_2 GO mm	d_2 mm	ID	ID	ID	ID
1	64	1.854	24	6.35	6	● 191577	● 191580	● 191583	● 191586
2	54	2.184	24	6.35	6	● 191578	● 191581	● 191584	● 191587
3	48	2.515	24	6.35	6	● 191579	● 191582	● 191585	● 191588
$\emptyset d_1$ UNF	P TPI	$\emptyset d_1$ mm	l_1 mm	l_2 GO mm	d_2 mm	ID	ID	ID	ID
0	80	1.524	24	4.76	6	● 191637	● 191641	● 191645	● 191649
1	72	1.854	24	4.76	6	● 191638	● 191642	● 191646	● 191650
2	64	2.184	24	4.76	6	● 191639	● 191643	● 191647	● 191651
3	56	2.515	24	4.76	6	● 191640	● 191644	● 191648	● 191652



All nano thread plug gauges are SCS-certified and the paid certificate is available on request.

UNC, UNF

ASME B1.1

DZ04: ASME B1.2 / DZ14: ASME B1.2, DC SWISS NI590

PHYN.
KL

nano

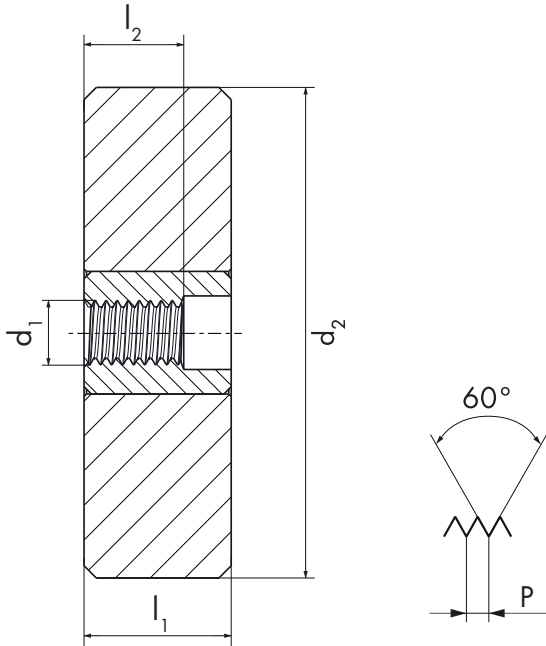

DZ04 GO

DZ14 NO-GO

DZ04 GO

DZ14 NO-GO



2A

2A

3A

3A

$\emptyset d_1$ UNC	P TPI	$\emptyset d_1$ mm	l_1 mm	l_2 GO mm	d_2 mm	ID	ID	ID	ID
1	64	1.854	6	2.78	20	● 191601	● 191604	● 191607	● 191610
2	56	2.184	6	3.28	20	● 191602	● 191605	● 191608	● 191611
3	48	2.515	6	3.77	20	● 191603	● 191606	● 191609	● 191612
$\emptyset d_1$ UNF	P TPI	$\emptyset d_1$ mm	l_1 mm	l_2 GO mm	d_2 mm	ID	ID	ID	ID
0	80	1.524	6	2.29	20	● 191669	● 191673	● 191677	● 191681
1	72	1.854	6	2.78	20	● 191670	● 191674	● 191678	● 191682
2	64	2.184	6	3.28	20	● 191671	● 191675	● 191679	● 191683
3	56	2.515	6	3.77	20	● 191672	● 191676	● 191680	● 191684



All nano ring gauges have a certificate of measurement, established with SCS certified plug check gauges. The paid certificate is available on request.

UNC, UNF

ASME B1.1

DN04: ASME B1.2 / DN14: ASME B1.2, DC SWISS NI590

PHYN.
KL

nano

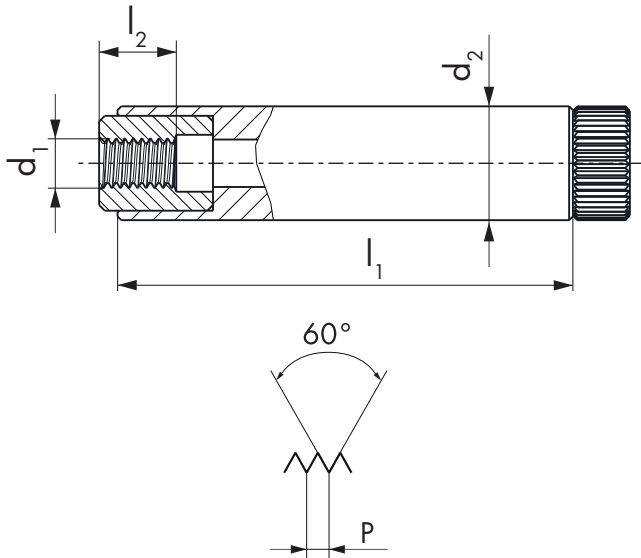

DN04 GO

DN14 NO-GO

DN04 GO

DN14 NO-GO



2A

2A

3A

3A

$\emptyset d_1$ UNC	P TPI	$\emptyset d_1$ mm	l_1 mm	l_2 GO mm	d_2 mm	ID	ID	ID	ID
1	64	1.854	24	2.78	6	● 191589	● 191592	● 191595	● 191598
2	56	2.184	24	3.28	6	● 191590	● 191593	● 191596	● 191599
3	48	2.515	24	3.77	6	● 191591	● 191594	● 191597	● 191600
$\emptyset d_1$ UNF	P TPI	$\emptyset d_1$ mm	l_1 mm	l_2 GO mm	d_2 mm	ID	ID	ID	ID
0	80	1.524	24	2.29	6	● 191653	● 191657	● 191661	● 191665
1	72	1.854	24	2.78	6	● 191654	● 191658	● 191662	● 191666
2	64	2.184	24	3.28	6	● 191655	● 191659	● 191663	● 191667
3	56	2.515	24	3.77	6	● 191656	● 191660	● 191664	● 191668



All nano ring gauges have a certificate of measurement, established with SCS certified plug check gauges. The paid certificate is available on request.

nano

DN01 GO

DN01 GO

DN02 NO-GO

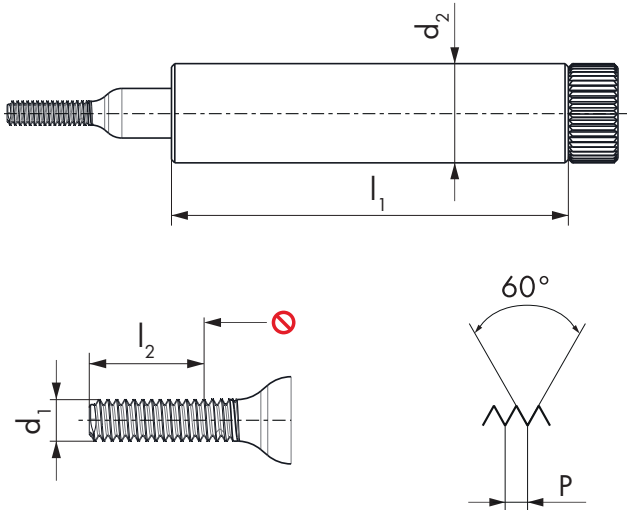

NIHS
3G

NIHS
4H

NIHS
4H/3G

$\emptyset d_1$ S	P mm	l_1 mm	l_2 GO mm	d_2 mm	ID	ID	ID
0.3	0.08	24	0.9	6	● 190733	● 193242	● 190752
0.35	0.09	24	1.05	6	● 190734	● 193243	● 190753
0.4	0.1	24	1.2	6	● 190735	● 193244	● 190754
0.5	0.125	24	1.5	6	● 190736	● 193245	● 190755
0.6	0.15	24	1.8	6	● 190737	● 193246	● 190756
0.7	0.175	24	2.1	6	● 190738	● 193247	● 190757
0.8	0.2	24	2.4	6	● 190739	● 193248	● 190758
0.9	0.225	24	2.7	6	● 190740	● 193249	● 190759
1	0.25	24	3	6	● 190741	● 193250	● 190760
1.2	0.25	24	3.6	6	● 190742	● 193251	● 190761
1.4	0.3	24	4.2	6	● 190743	● 193252	● 190762



All nano thread plug gauges are SCS-certified and the paid certificate is available on request.

nano

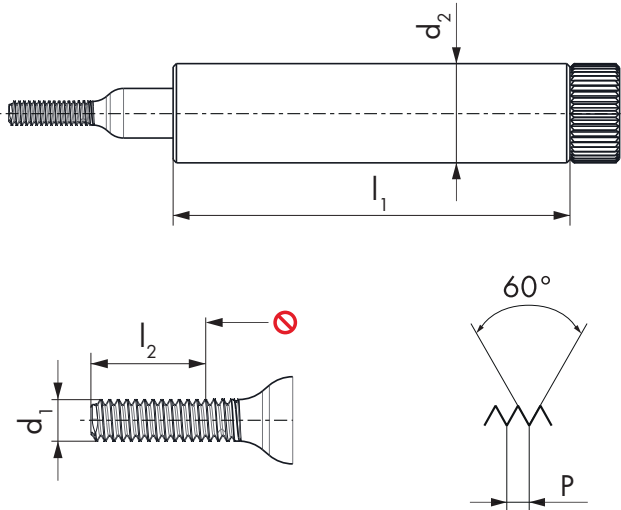

DN01 GO

DN02 NO-GO



$\emptyset d_1$ S	P mm	l_1 mm	l_2 GO mm	d_2 mm	ID	ID
0.3	0.08	24	0.9	6	● 190771	● 190790
0.35	0.09	24	1.05	6	● 190772	● 190791
0.4	0.1	24	1.2	6	● 190773	● 190792
0.5	0.125	24	1.5	6	● 190774	● 190793
0.6	0.15	24	1.8	6	● 190775	● 190794
0.7	0.175	24	2.1	6	● 190776	● 190795
0.8	0.2	24	2.4	6	● 190777	● 190796
0.9	0.225	24	2.7	6	● 190778	● 190797
1	0.25	24	3	6	● 190779	● 190798
1.2	0.25	24	3.6	6	● 190780	● 190799
1.4	0.3	24	4.2	6	● 190781	● 190800



All nano thread plug gauges are SCS-certified and the paid certificate is available on request.

nano

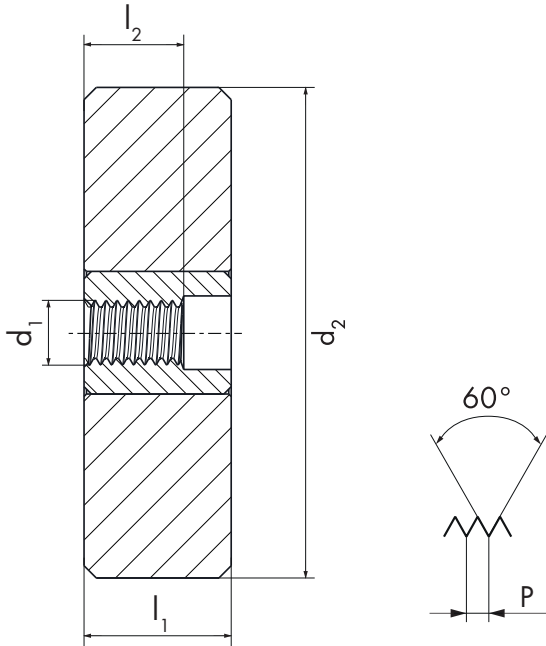

DZ04 GO

DZ14 NO-GO

DZ04 GO

DZ14 NO-GO



$\emptyset d_1$ S	P mm	l_1 mm	l_2 GO mm	d_2 mm	ID	ID	ID	ID
* 0.3	0.08	6	0.45	20	● 190809	● 190828	● 190847	● 190866
* 0.35	0.09	6	0.53	20	● 190810	● 190829	● 190848	● 190867
0.4	0.1	6	0.6	20	● 190811	● 190830	● 190849	● 190868
0.5	0.125	6	0.75	20	● 190812	● 190831	● 190850	● 190869
0.6	0.15	6	0.9	20	● 190813	● 190832	● 190851	● 190870
0.7	0.175	6	1.05	20	● 190814	● 190833	● 190852	● 190871
0.8	0.2	6	1.2	20	● 190815	● 190834	● 190853	● 190872
0.9	0.225	6	1.35	20	● 190816	● 190835	● 190854	● 190873
1	0.25	6	1.5	20	● 190817	● 190836	● 190855	● 190874
1.2	0.25	6	1.8	20	● 190818	● 190837	● 190856	● 190875
1.4	0.3	6	2.1	20	● 190819	● 190838	● 190857	● 190876

* In development



All nano ring gauges have a certificate of measurement, established with SCS certified plug check gauges. The paid certificate is available on request.

nano

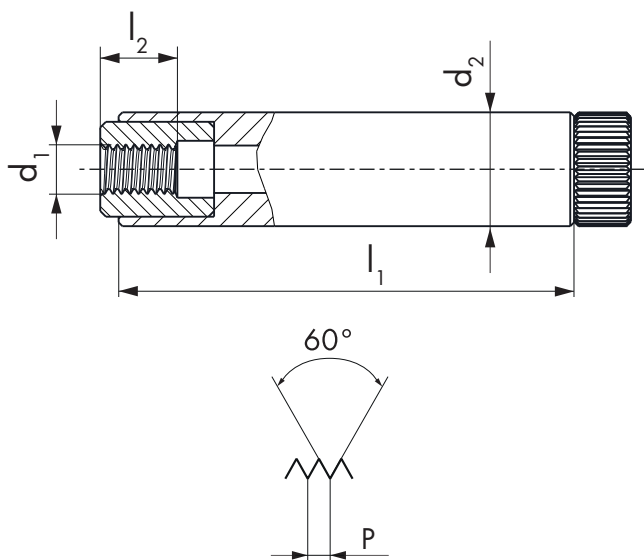

DN04 GO

DN14 NO-GO

DN04 GO

DN14 NO-GO



$\emptyset d_1$ S	P mm	l_1 mm	l_2 GO mm	d_2 mm	ID	ID	ID	ID
* 0.3	0.08	24	0.45	6	● 190885	● 190904	● 190923	● 190942
* 0.35	0.09	24	0.53	6	● 190886	● 190905	● 190924	● 190943
0.4	0.1	24	0.6	6	● 190887	● 190906	● 190925	● 190944
0.5	0.125	24	0.75	6	● 190888	● 190907	● 190926	● 190945
0.6	0.15	24	0.9	6	● 190889	● 190908	● 190927	● 190946
0.7	0.175	24	1.05	6	● 190890	● 190909	● 190928	● 190947
0.8	0.2	24	1.2	6	● 190891	● 190910	● 190929	● 190948
0.9	0.225	24	1.35	6	● 190892	● 190911	● 190930	● 190949
1	0.25	24	1.5	6	● 190893	● 190912	● 190931	● 190950
1.2	0.25	24	1.8	6	● 190894	● 190913	● 190932	● 190951
1.4	0.3	24	2.1	6	● 190895	● 190914	● 190933	● 190952

*In development



All nano ring gauges have a certificate of measurement, established with SCS certified plug check gauges. The paid certificate is available on request.

nano

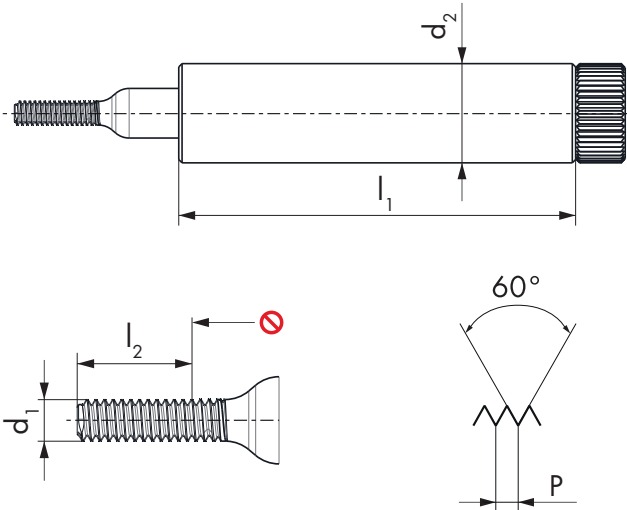

DN01 GO

DN01 GO

DN02 NO-GO



$\emptyset d_1$ SF	P mm	l_1 mm	l_2 GO mm	d_2 mm	ID	ID	ID
1.4	0.2	24	4.2	6	● 190744	● 193256	● 190763
1.6	0.2	24	3	6	● 190745	● 193257	● 190764
1.8	0.2	24	3	6	● 190746	● 193258	● 190765
2	0.2	24	3	6	● 190747	● 193259	● 190766
2.2	0.2	24	3	6	● 190748	● 193260	● 190767
2.2	0.25	24	3	6	● 190749	● 193261	● 190768
2.5	0.2	24	3	6	● 190750	● 193262	● 190769
2.5	0.25	24	3	6	● 190751	● 193263	● 190770

nano



All nano thread plug gauges are SCS-certified and the paid certificate is available on request.

nano

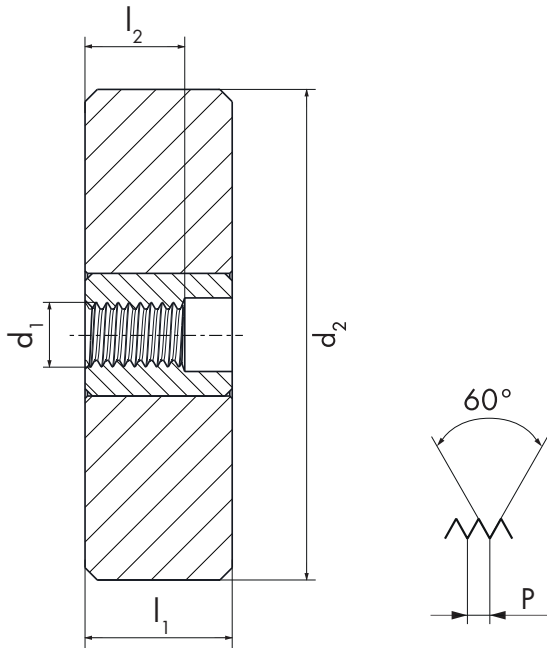

DZ04 GO

DZ14 NO-GO



$\emptyset d_1$ SF	P mm	l_1 mm	l_2 GO mm	d_2 mm	ID	ID
1.4	0.2	6	2.1	20	● 190820	● 190839
1.6	0.2	6	1.8	20	● 190821	● 190840
1.8	0.2	6	1.8	20	● 190822	● 190841
2	0.2	6	1.8	20	● 190823	● 190842
2.2	0.2	6	1.8	20	● 190824	● 190843
2.2	0.25	6	2.25	20	● 190825	● 190844
2.5	0.2	6	1.8	20	● 190826	● 190845
2.5	0.25	6	2.25	20	● 190827	● 190846



All nano ring gauges have a certificate of measurement, established with SCS certified plug check gauges. The paid certificate is available on request.

nano

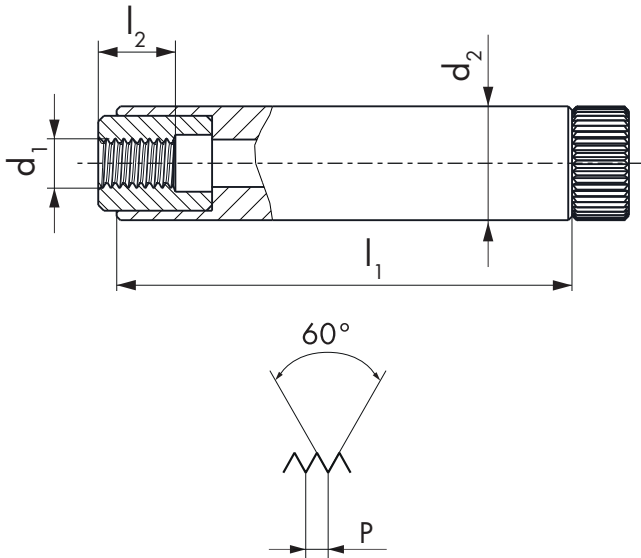

DN04 GO

DN14 NO-GO



$\emptyset d_1$ SF	P mm	l_1 mm	l_2 GO mm	d_2 mm	ID	ID
1.4	0.2	24	2.1	6	● 190896	● 190915
1.6	0.2	24	1.8	6	● 190897	● 190916
1.8	0.2	24	1.8	6	● 190898	● 190917
2	0.2	24	1.8	6	● 190899	● 190918
2.2	0.2	24	1.8	6	● 190900	● 190919
2.2	0.25	24	2.25	6	● 190901	● 190920
2.5	0.2	24	1.8	6	● 190902	● 190921
2.5	0.25	24	2.28	6	● 190903	● 190922



All nano ring gauges have a certificate of measurement, established with SCS certified plug check gauges. The paid certificate is available on request.

nano

DN01 GO

DN02 NO-GO

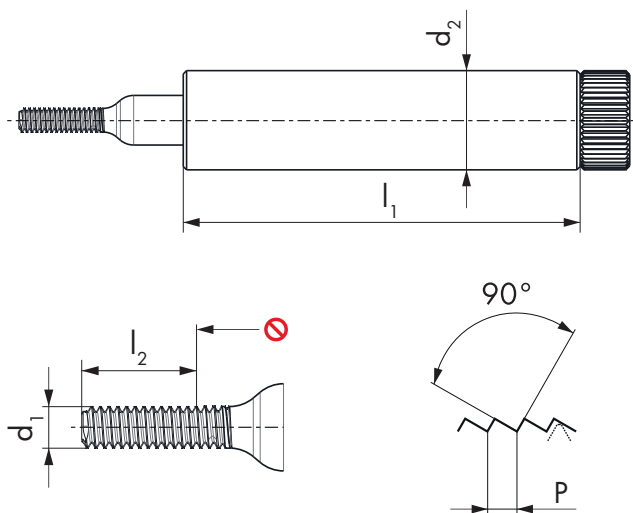

$\emptyset d_1$ SL	P mm	l_1 mm	l_2 GO mm	d_2 mm	ID	ID
0.5	0.1	24	1.5	6	● 600178	● 600186
0.6	0.125	24	1.8	6	● 600179	● 600187
0.7	0.15	24	2.1	6	● 600180	● 600188
0.8	0.15	24	2.4	6	● 600181	● 600189
0.9	0.175	24	2.7	6	● 600182	● 600190
1	0.2	24	3	6	● 600183	● 600191
1.2	0.2	24	3.6	6	● 600184	● 600192
1.4	0.25	24	4.2	6	● 600185	● 600193



All nano thread plug gauges are SCS-certified and the paid certificate is available on request.

nano

RN05-1 GO

RN15-1 GO

RN05-1 GO

RN15-1 GO

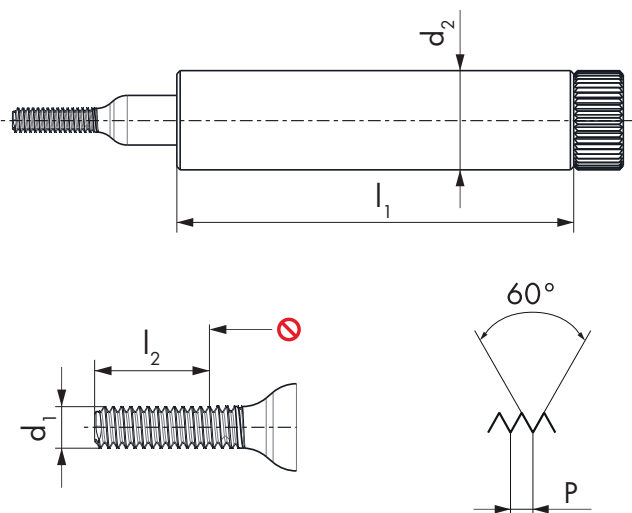

5h

5h

6h

6h

$\emptyset d_1$ M	P mm	l_1 mm	l_2 GO mm	d_2 mm	ID	ID	ID	ID
0.3	0.08	24	0.61	6	● 192884	● 192892		
0.35	0.09	24	0.71	6	● 192885	● 192893		
0.4	0.1	24	0.8	6	● 192886	● 192894		
0.5	0.125	24	1	6	● 192887	● 192895		
0.6	0.15	24	1.2	6	● 192888	● 192896		
0.7	0.175	24	1.4	6	● 192889	● 192897		
0.8	0.2	24	1.6	6	● 192890	● 192898		
0.9	0.225	24	1.8	6	● 192891	● 192899		
1	0.25	24	2	6			● 191499	● 191508
1.2	0.25	24	2.3	6			● 191500	● 191509
1.4	0.3	24	2.7	6			● 191501	● 191510

6g

6g

$\emptyset d_1$ M	P mm	l_1 mm	l_2 GO mm	d_2 mm	ID	ID
1.6	0.35	24	3.1	6	● 191517	● 191535
1.8	0.35	24	3.4	6	● 191518	● 191536
2	0.4	24	3.8	6	● 191519	● 191537
2.3	0.4	24	4.25	6	● 191520	● 191538
2.5	0.45	24	4.65	6	● 191521	● 191539
2.6	0.45	24	4.8	6	● 191522	● 191540



SCS certificate included.

nano

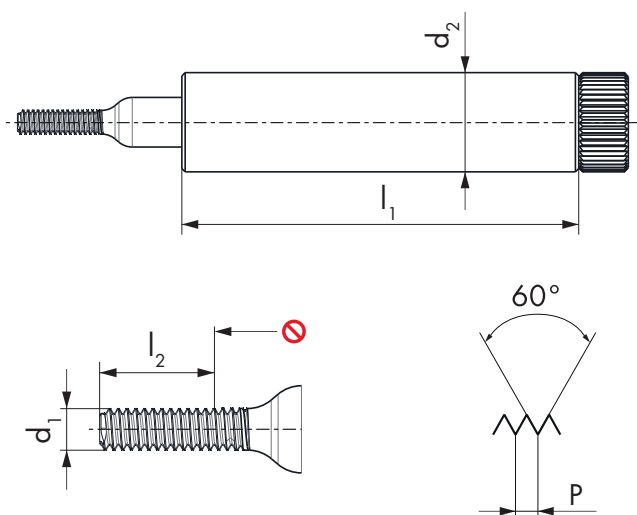

**RN05-2
NO-GO** **RN15-2
NO-GO** **RN05-2
NO-GO** **RN15-2
NO-GO**



5h **5h** **6h** **6h**

$\emptyset d_1$ M	P mm	l_1 mm	l_2 GO mm	d_2 mm	ID	ID	ID	ID
0.3	0.08	24	0.61	6	● 192900	● 192908		
0.35	0.09	24	0.71	6	● 192901	● 192909		
0.4	0.1	24	0.8	6	● 192902	● 192910		
0.5	0.125	24	1	6	● 192903	● 192911		
0.6	0.15	24	1.2	6	● 192904	● 192912		
0.7	0.175	24	1.4	6	● 192905	● 192913		
0.8	0.2	24	1.6	6	● 192906	● 192914		
0.9	0.225	24	1.8	6	● 192907	● 192915		
1	0.25	24	2	6			● 191502	● 191511
1.2	0.25	24	2.3	6			● 191503	● 191512
1.4	0.3	24	2.7	6			● 191504	● 191513

6g **6g**

$\emptyset d_1$ M	P mm	l_1 mm	l_2 GO mm	d_2 mm	ID	ID
1.6	0.35	24	3.1	6	● 191523	● 191541
1.8	0.35	24	3.4	6	● 191524	● 191542
2	0.4	24	3.8	6	● 191525	● 191543
2.3	0.4	24	4.25	6	● 191526	● 191544
2.5	0.45	24	4.65	6	● 191527	● 191545
2.6	0.45	24	4.8	6	● 191528	● 191546



SCS certificate included.



ISO DIN 13
ISO 1502

VHM
CAR

nano

RN05-3
WEAR

RN15-3
WEAR

RN05-3
WEAR

RN15-3
WEAR

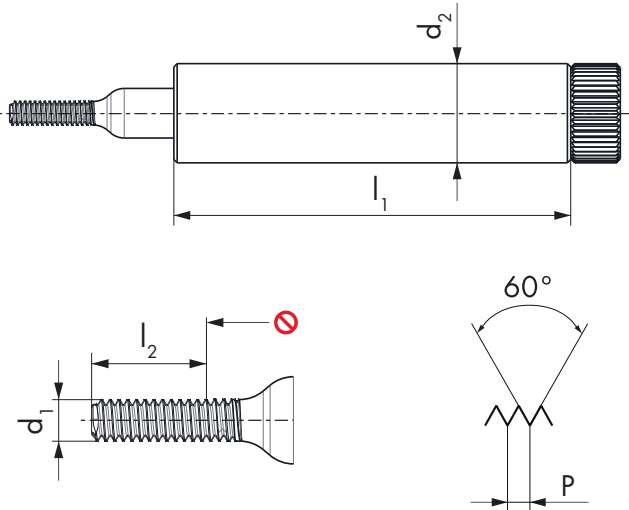

6h

6h

6g

6g

$\emptyset d_1$ M	P mm	l_1 mm	l_2 GO mm	d_2 mm	ID	ID	ID	ID
1	0.25	24	2	6	● 191505	● 191514		
1.2	0.25	24	2.3	6	● 191506	● 191515		
1.4	0.3	24	2.7	6	● 191507	● 191516		
1.6	0.35	24	3.1	6			● 191529	● 191547
1.8	0.35	24	3.4	6			● 191530	● 191548
2	0.4	24	3.8	6			● 191531	● 191549
2.3	0.4	24	4.25	6			● 191532	● 191550
2.5	0.45	24	4.65	6			● 191533	● 191551
2.6	0.45	24	4.8	6			● 191534	● 191552



SCS certificate included.



nano

RN05-1 GO

RN15-1 GO

RN05-1 GO

RN15-1 GO

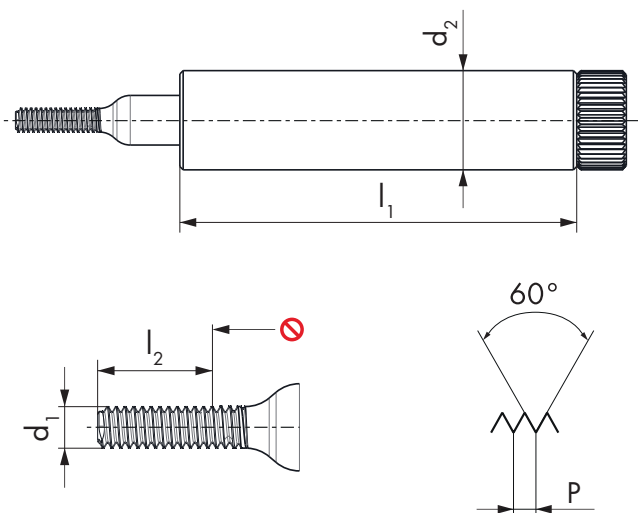

4h

4h

6h

6h

$\emptyset d_1$ MF	P mm	l_1 mm	l_2 GO mm	d_2 mm	ID	ID	ID	ID
1.4	0.2	24	2.5	6	● 191256	● 191298	● 192932	● 192945
1.6	0.2	24	2.2	6	● 195874	● 195876	● 192933	● 192946
1.8	0.2	24	2.2	6	● 197711	● 197712	● 192934	● 192947
2	0.2	24	2.2	6	● 197724	● 197725	● 192935	● 192948
2	0.25	24	2.75	6	● 197726	● 197727	● 192936	● 192949
2.2	0.2	24	2.2	6	● 197713	● 197714	● 192937	● 192950
2.2	0.25	24	2.75	6	● 197715	● 197716	● 192938	● 192951
2.3	0.2	24	2.2	6	● 197717	● 197718	● 192939	● 192952
2.3	0.25	24	2.75	6	● 197719	● 197720	● 192940	● 192953
2.5	0.2	24	2.2	6	● 197721	● 197722	● 192941	● 192954
2.5	0.25	24	2.75	6	● 190683	● 197723	● 192942	● 192955
							6g	6g
$\emptyset d_1$ MF	P mm	l_1 mm	l_2 GO mm	d_2 mm	ID	ID		
2.5	0.35	24	4.45	6		● 192943	● 192956	
2.6	0.35	24	4.6	6		● 192944	● 192957	



SCS certificate included.

nano

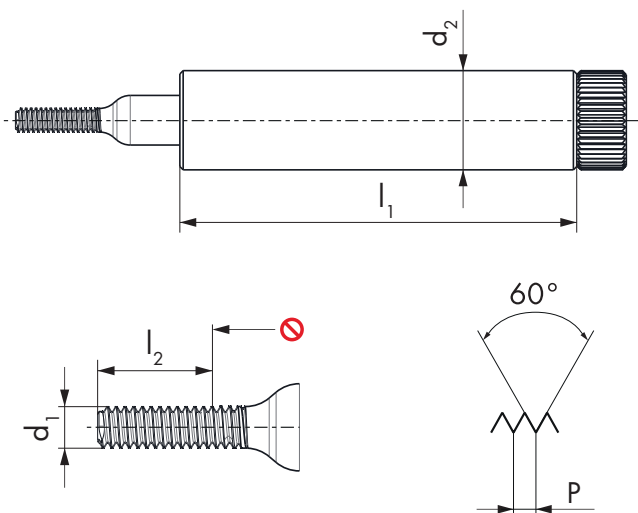

**RN05-2
NO-GO**

**RN15-2
NO-GO**

**RN05-2
NO-GO**

**RN15-2
NO-GO**



4h

4h

6h

6h

$\emptyset d_1$ MF	P mm	l_1 mm	l_2 GO mm	d_2 mm	ID	ID	ID	ID
1.4	0.2	24	2.5	6	● 191270	● 197728	● 192958	● 192971
1.6	0.2	24	1.6	6	● 195875	● 195877	● 192959	● 192972
1.8	0.2	24	1.6	6	● 197729	● 197730	● 192960	● 192973
2	0.2	24	1.6	6	● 199060	● 199061	● 192961	● 192974
2	0.25	24	2	6	● 199062	● 199063	● 192962	● 192975
2.2	0.2	24	1.6	6	● 197731	● 197732	● 192963	● 192976
2.2	0.25	24	2	6	● 197733	● 199364	● 192964	● 192977
2.3	0.2	24	1.6	6	● 199053	● 199054	● 192965	● 192978
2.3	0.25	24	2	6	● 199055	● 199056	● 192966	● 192979
2.5	0.2	24	1.6	6	● 199057	● 199058	● 192967	● 192980
2.5	0.25	24	2	6	● 190686	● 199059	● 192968	● 192981

6g

6g

$\emptyset d_1$ MF	P mm	l_1 mm	l_2 GO mm	d_2 mm	ID	ID
2.5	0.35	24	4.45	6	● 192969	● 192982
2.6	0.35	24	4.6	6	● 192970	● 192983



SCS certificate included.

nano

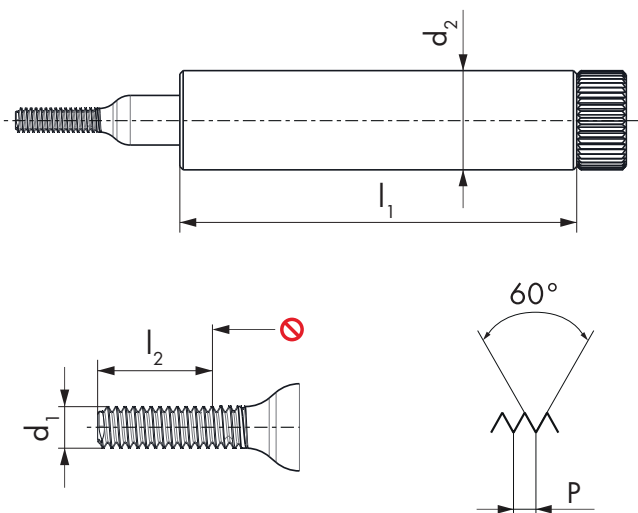

**RN05-3
WEAR**

**RN15-3
WEAR**

**RN05-3
WEAR**

**RN15-3
WEAR**



4h

4h

6h

6h

$\emptyset d_1$ MF	P mm	l_1 mm	l_2 G0 mm	d_2 mm	ID	ID	ID	ID
1.4	0.2	24	2.5	6	● 191284	● 191326	● 192984	● 192997
1.6	0.2	24	1.6	6	● 199064	● 199065	● 192985	● 192998
1.8	0.2	24	1.6	6	● 199066	● 199067	● 192986	● 192999
2	0.2	24	1.6	6	● 199360	● 199361	● 192987	● 193000
2	0.25	24	2	6	● 199362	● 199363	● 192988	● 193001
2.2	0.2	24	1.6	6	● 199068	● 199069	● 192989	● 193002
2.2	0.25	24	2	6	● 199070	● 199071	● 192990	● 193003
2.3	0.2	24	1.6	6	● 199072	● 199073	● 192991	● 193004
2.3	0.25	24	2	6	● 199074	● 199075	● 192992	● 193005
2.5	0.2	24	1.6	6	● 199076	● 199077	● 192993	● 193006
2.5	0.25	24	2	6	● 199358	● 199359	● 192994	● 193007

6g

6g

$\emptyset d_1$ MF	P mm	l_1 mm	l_2 G0 mm	d_2 mm	ID	ID
2.5	0.35	24	4.45	6	● 192995	● 193008
2.6	0.35	24	4.6	6	● 192996	● 193009



SCS certificate included.

UNC, UNF ASME B1.1 DC SWISS NI582

VHM
CAR

nano

RN05-1 GO

RN15-1 GO

RN05-1 GO

RN15-1 GO

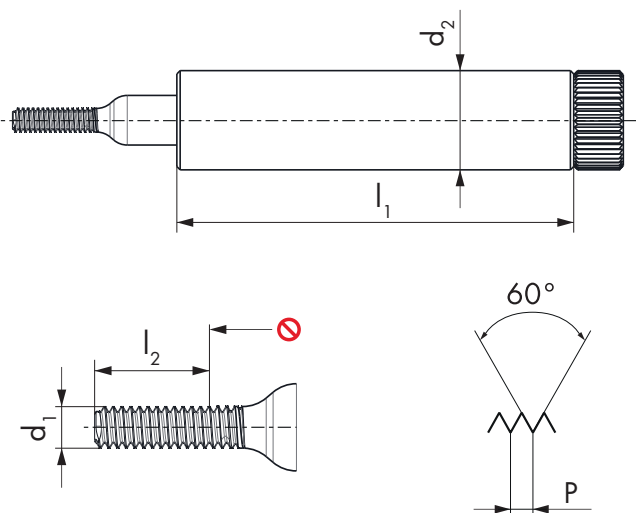

2A

2A

3A

3A

$\emptyset d_1$ UNC	P TPI	$\emptyset d_1$ mm	l_1 mm	l_2 GO mm	d_2 mm	ID	ID	ID	ID
1	64	1.854	24	3.58	6	● 191613	● 191619	● 191625	● 191631
2	56	2.184	24	4.18	6	● 191614	● 191620	● 191626	● 191632
3	48	2.515	24	4.83	6	● 191615	● 191621	● 191627	● 191633
$\emptyset d_1$ UNF	P TPI	$\emptyset d_1$ mm	l_1 mm	l_2 GO mm	d_2 mm	ID	ID	ID	ID
0	80	1.524	24	2.92	6	● 191685	● 191693	● 191701	● 191709
1	72	1.854	24	3.49	6	● 191686	● 191694	● 191702	● 191710
2	64	2.184	24	4.07	6	● 191687	● 191695	● 191703	● 191711
3	56	2.515	24	4.68	6	● 191688	● 191696	● 191704	● 191712



SCS certificate included.



nano

UNC, UNF ASME B1.1 DC SWISS NI582

VHM
CAR

nano

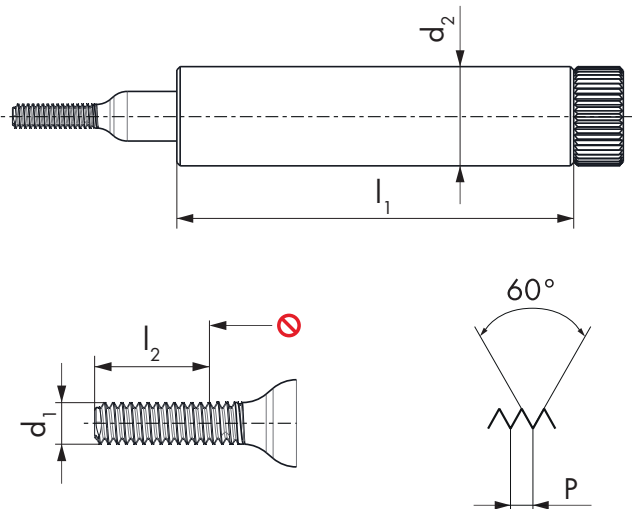

RN05-2
NO-GO

RN15-2
NO-GO

RN05-2
NO-GO

RN15-2
NO-GO



2A

2A

3A

3A

$\emptyset d_1$ UNC	P TPI	$\emptyset d_1$ mm	l_1 mm	l_2 GO mm	d_2 mm	ID	ID	ID	ID
1	64	1.854	24	3.58	6	● 191616	● 191622	● 191628	● 191634
2	56	2.184	24	4.18	6	● 191617	● 191623	● 191629	● 191635
3	48	2.515	24	4.83	6	● 191618	● 191624	● 191630	● 191636
$\emptyset d_1$ UNF	P TPI	$\emptyset d_1$ mm	l_1 mm	l_2 GO mm	d_2 mm	ID	ID	ID	ID
0	80	1.524	24	2.92	6	● 191689	● 191697	● 191705	● 191713
1	72	1.854	24	3.49	6	● 191690	● 191698	● 191706	● 191714
2	64	2.184	24	4.07	6	● 191691	● 191699	● 191707	● 191715
3	56	2.515	24	4.68	6	● 191692	● 191700	● 191708	● 191716



SCS certificate included.

nano

RN05-1 GO

RN15-1 GO

RN05-1 GO

RN15-1 GO

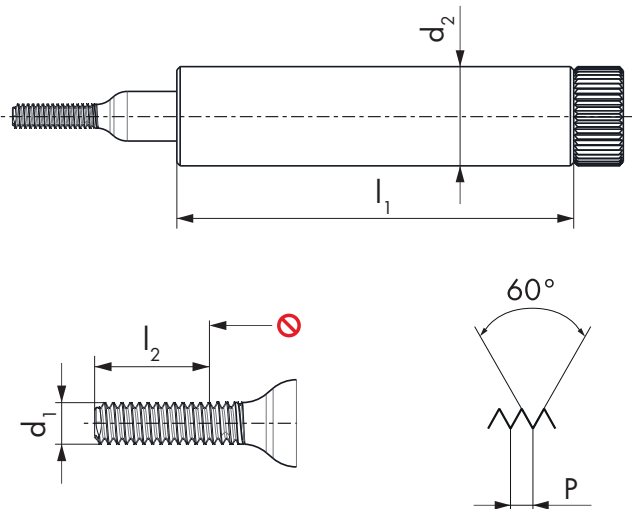

$\emptyset d_1$ S	P mm	l_1 mm	l_2 GO mm	d_2 mm	ID	ID	ID	ID
0.3	0.08	24	0.61	6	● 190961	● 190999	● 191037	● 191075
0.35	0.09	24	0.71	6	● 190962	● 191000	● 191038	● 191076
0.4	0.1	24	0.8	6	● 190963	● 191001	● 191039	● 191077
0.5	0.125	24	1	6	● 190964	● 191002	● 191040	● 191078
0.6	0.15	24	1.2	6	● 190965	● 191003	● 191041	● 191079
0.7	0.175	24	1.4	6	● 190966	● 191004	● 191042	● 191080
0.8	0.2	24	1.6	6	● 190967	● 191005	● 191043	● 191081
0.9	0.225	24	1.8	6	● 190968	● 191006	● 191044	● 191082
1	0.25	24	2	6	● 190969	● 191007	● 191045	● 191083
1.2	0.25	24	2.3	6	● 190970	● 191008	● 191046	● 191084
1.4	0.3	24	2.7	6	● 190971	● 191009	● 191047	● 191085



SCS certificate included.

nano

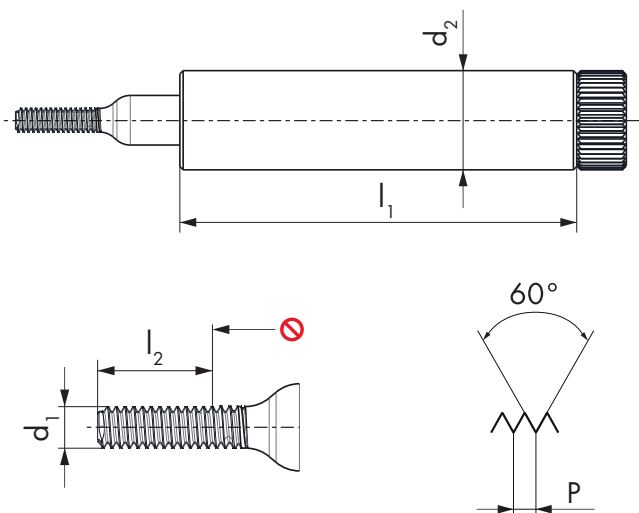

RN05-2
NO-GO

RN15-2
NO-GO

RN05-2
NO-GO

RN15-2
NO-GO



NIHS

NIHS

NIHS
NT

NIHS
NT

$\emptyset d_1$ S	P mm	l_1 mm	l_2 GO mm	d_2 mm	ID	ID	ID	ID
0.3	0.08	24	0.61	6	● 190980	● 191018	● 191056	● 191094
0.35	0.09	24	0.71	6	● 190981	● 191019	● 191057	● 191095
0.4	0.1	24	0.8	6	● 190982	● 191020	● 191058	● 191096
0.5	0.125	24	1	6	● 190983	● 191021	● 191059	● 191097
0.6	0.15	24	1.2	6	● 190984	● 191022	● 191060	● 191098
0.7	0.175	24	1.4	6	● 190985	● 191023	● 191061	● 191099
0.8	0.2	24	1.6	6	● 190986	● 191024	● 191062	● 191100
0.9	0.225	24	1.8	6	● 190987	● 191025	● 191063	● 191101
1	0.25	24	2	6	● 190988	● 191026	● 191064	● 191102
1.2	0.25	24	2.3	6	● 190989	● 191027	● 191065	● 191103
1.4	0.3	24	2.7	6	● 190990	● 191028	● 191066	● 191104



SCS certificate included.

nano

RN05-1 GO

RN15-1 GO

RN05-1 GO

RN15-1 GO

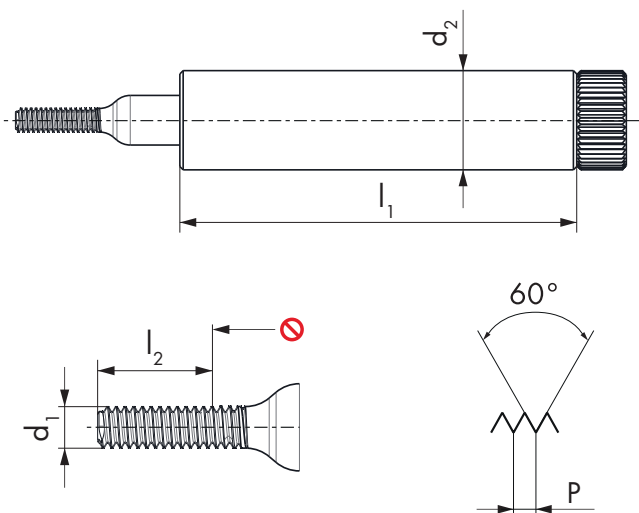

$\emptyset d_1$ SF	P mm	l_1 mm	l_2 GO mm	d_2 mm	ID	ID	ID	ID
1.4	0.2	24	2.5	6	● 190972	● 191010	● 191048	● 191086
1.6	0.2	24	2.2	6	● 190973	● 191011	● 191049	● 191087
1.8	0.2	24	2.2	6	● 190974	● 191012	● 191050	● 191088
2	0.2	24	2.2	6	● 190975	● 191013	● 191051	● 191089
2.2	0.2	24	2.2	6	● 190976	● 191014	● 191052	● 191090
2.2	0.25	24	2.75	6	● 190977	● 191015	● 191053	● 191091
2.5	0.2	24	2.2	6	● 190978	● 191016	● 191054	● 191092
2.5	0.25	24	2.75	6	● 190979	● 191017	● 191055	● 191093



SCS certificate included.

nano

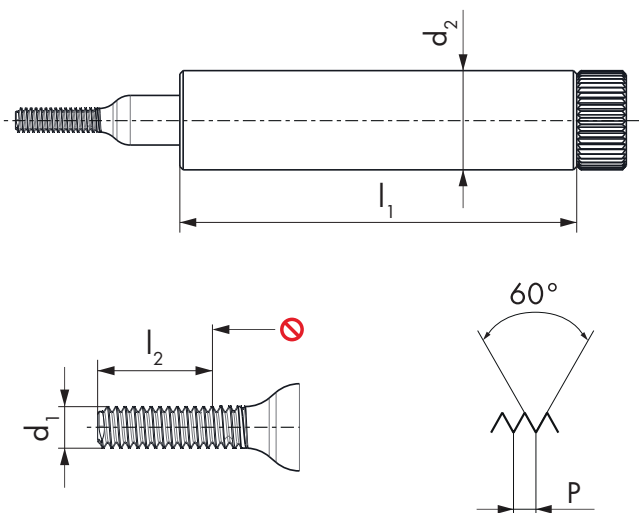

RN05-2
NO-GO

RN15-2
NO-GO

RN05-2
NO-GO

RN15-2
NO-GO



$\emptyset d_1$ SF	P mm	l_1 mm	l_2 GO mm	d_2 mm	ID	ID	ID	ID
1.4	0.2	24	2.5	6	● 190991	● 191029	● 191067	● 191105
1.6	0.2	24	1.6	6	● 190992	● 191030	● 191068	● 191106
1.8	0.2	24	1.6	6	● 190993	● 191031	● 191069	● 191107
2	0.2	24	1.6	6	● 190994	● 191032	● 191070	● 191108
2.2	0.2	24	1.6	6	● 190995	● 191033	● 191071	● 191109
2.2	0.25	24	2	6	● 190996	● 191034	● 191072	● 191110
2.5	0.2	24	1.6	6	● 190997	● 191035	● 191073	● 191111
2.5	0.25	24	2	6	● 190998	● 191036	● 191074	● 191112



SCS certificate included.

nano

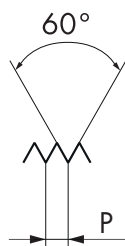
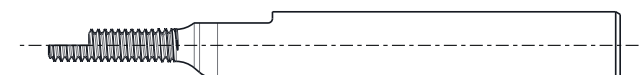
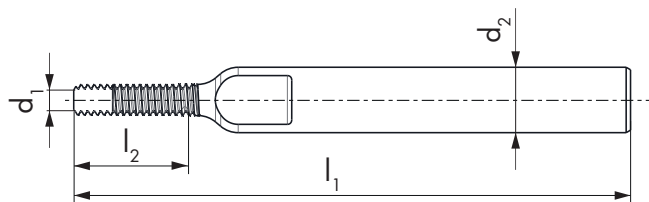

EN00



NIHS

$\varnothing d_1$ S	P mm	l_1 mm	l_2 GO mm	d_2 mm	ID
0.3	0.08	39	1.28	3	● 192747
0.35	0.09	39	1.44	3	● 192748
0.4	0.1	39	1.6	3	● 192749
0.5	0.125	39	2	3	● 192750
0.6	0.15	39	2.4	3	● 192751
0.7	0.175	39	2.8	3	● 192752
0.8	0.2	39	3.2	3	● 192753
0.9	0.225	39	3.6	3	● 192754
1	0.25	39	4	3	● 192755
1.2	0.25	39	4	3	● 192756
1.4	0.3	39	4.8	3	● 192757

La jauge étalon filetée de DC SWISS sert à calibrer les machines de mesure. Les étalons de notre catalogue, ou réalisés selon vos besoins spécifiques, sont livrés avec un certificat de mesure SCS confirmant que la production a suivi scrupuleusement le processus de contrôle au terme de la fabrication selon ISO 17025. Il atteste la qualité de l'équipement métrologique de DC NANO TOOLS SA (SCS 0143), centre de compétences et membre du Groupe DC SWISS.

Il campione filettato DC SWISS viene utilizzato per calibrare le macchine di misura. I campioni filettati del nostro catalogo o prodotti secondo le vostre specifiche esigenze, sono forniti con un certificato di misura SCS. Ciò conferma che il processo di controllo durante la produzione è stato scrupolosamente eseguito in conformità alla norma ISO 17025. Egli certifica la qualità delle apparecchiature metrologiche di DC NANO TOOLS SA (SCS 0143), centro di competenza e membro del Gruppo DC SWISS.



SCS certificate included.